

20.06.2012

Assembling procedure

DV 1 Skylark

Part II.



Part II.

4.5. Rudder

4.5.1 Upper and Lower hinge preparation

- Lower (Fig. 47A) and upper (Fig. 47B) rudder hinge grease with graphite grease.
- Upper hinge: put on the sliding plastic washer and then put through the triangular upper holder with pressed case inside (Fig. 48 A-F). Secure the upper rudder hinge with a washer and pin. Pins ends spread wide to lock it.
- Lower hinge: put on the sliding plastic washer (Fig. 47C)

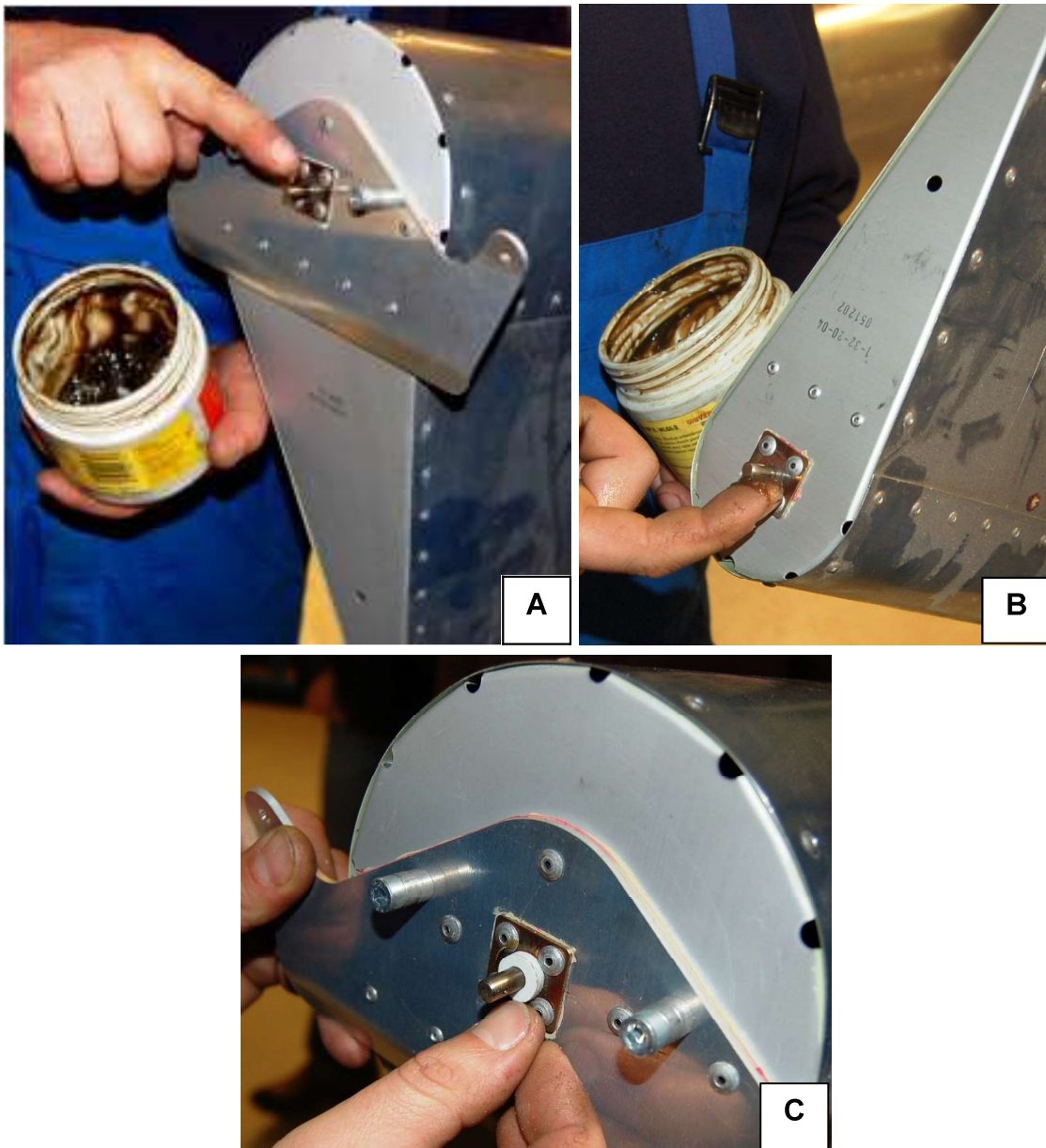

Obr. 47 A, B, C

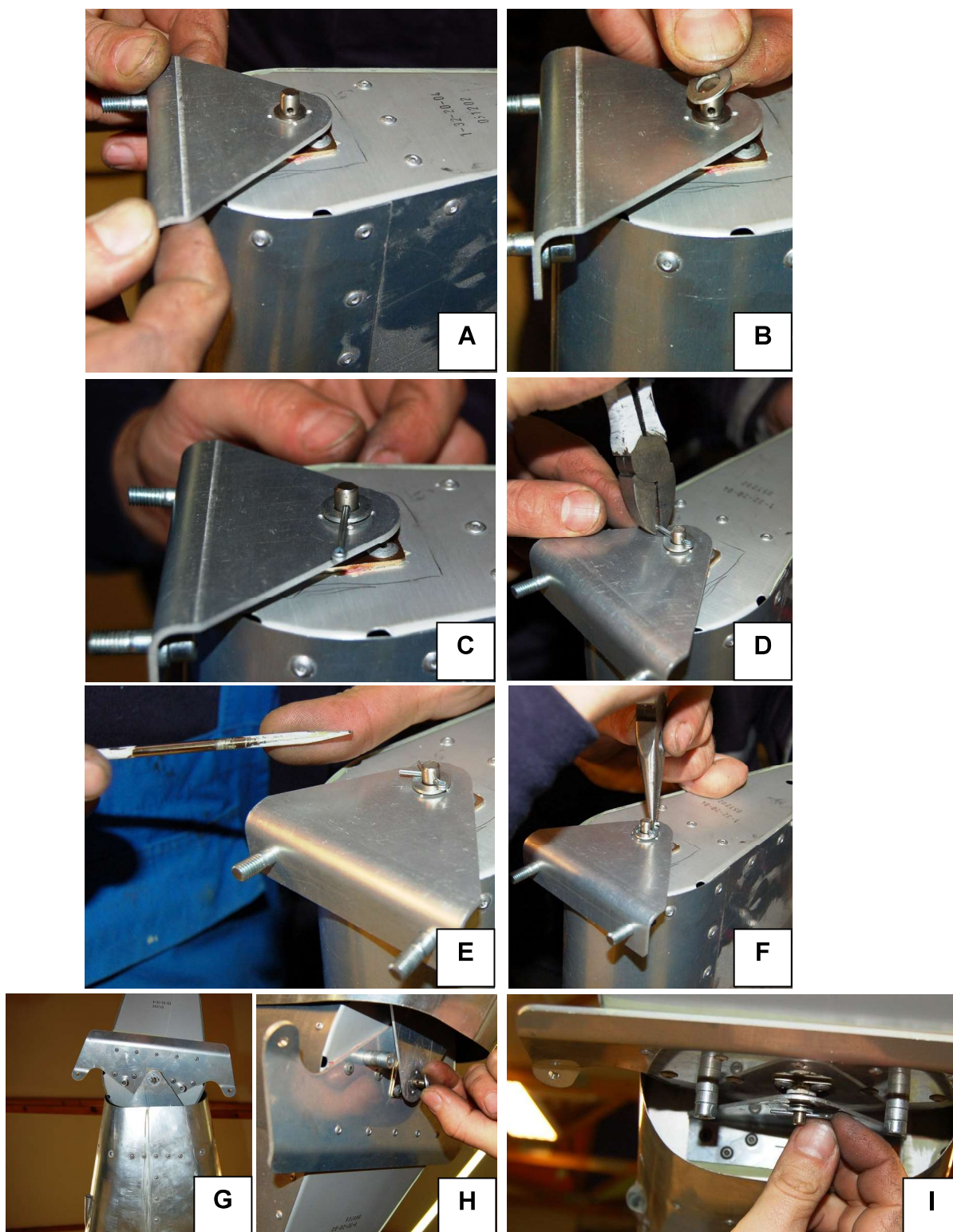

Fig. 48 A, B, C, D, E, F, G, H, I

- Put on the rudder into lower rudder holder on the fuselage tail. Connect the upper holder into the fin and secure with M6 self-locking nuts.
- Secure the lower rudder hinge with washer and pin.



Fig. 48 A, B, C, D